

F145-3 PRESSURE REFUELING NOZZLE

Product Description

The F145-3 single point nozzle is smaller and lighter in weight, yet maintains the strength, durability and robust design characteristics of the F116/F117 and HU3000/HU4000 series nozzles. The F145-3 provides a positive leak-tight connection to the aircraft adapter during fuelling operations. It has been designed to use all of the same accessories that are currently available on the F116/F117 series nozzles and is therefore able to be configured to meet any application.

Key features and benefits

- Designed and tested to SAE specification AS5877 Rev B
- 6 slot connector, which mates to the standard 3-lug international aircraft adapter
- Accepts all the same accessories as both the F116 and F117 nozzles
- Nose seal is interchangeable with the F117 nozzles
- Handles are interchangeable with the F117 nozzle
- Poppet does not require adjustment
- Maximum operating pressure, 150 psi (10.3 bar)
- Operating temperature range, -35°F to 160°F (-37°C to 71°C)
- Longer operating handle for ease of operation

Additional features

- Floating nose seal design, tolerant to temperature variation, worn adapters and operational environmental abuse
- Dual 3/8"NPT ports available for sampling and vacuum breaker
- Positive interlock mechanism, internal to the nozzle body. Nozzle cannot be opened unless connected to an aircraft adapter and cannot be removed unless operating lever is in the closed position
- Sacrificial wear block, available for additional protection
- Hose end control valves available in, 35 psi (2.4 bar), 45 psi (3.1 bar), 50 psi (3.4 bar), and 55 psi (3.8 bar)
- Easy to operate swivel dry disconnect available for strainer check
- Net weight of basic nozzle - 6.1 Pounds (2.7 KG)



F145-3 MODS

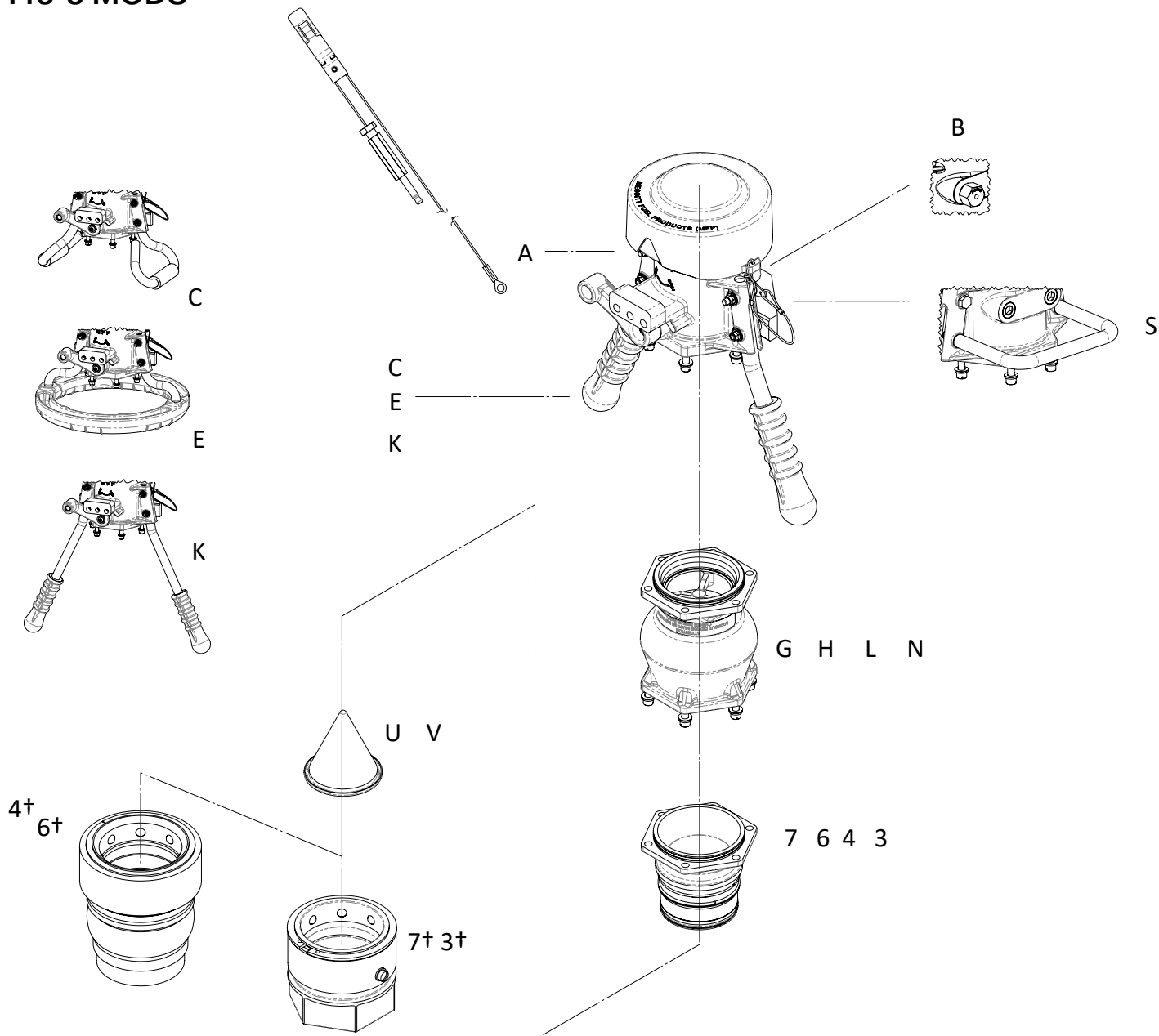

Model Variations

Model Variations

The F145-3 series nozzle is a straight-in fuelling nozzle. It is equipped with bicycle-type grip handles and a dust cover. Refer to Tables 2, and 3 for the available F145-3 series nozzle variations.

An explanation of the F145-3 series part numbering system is as follows:

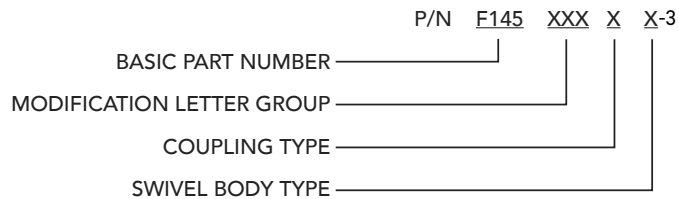

P/N Examples:

F145ABGVX7B-3 – This six (6) slot nozzle is equipped with a vacuum breaker and a ground cable with a 100 mesh strainer. This adds a 45 psi HECV, along with a 2.5 inch aluminium coupling that has a wire raceway to mate with the F582 swivel body, finishing with a 2.5 inch BSPPL inlet.

Model Variations

Table 1.

Mod Letter Group	Description
A	Adds Grounding Cable
B	Adds Vacuum Breaker
C	Stirrup Handles
E	Ring Handles
G	Adds 45 PSI HECV (Flanged)
H	Adds 35 PSI HECV (Flanged)
K	10"Long Handles
L	Adds 50 PSI HECV (Flanged)
N	Adds 55 PSI HECV (Flanged)
S	Interlock Safety Bracket
T	Adds 40 Mesh Strainer
U	Adds 60 Mesh Strainer
V	Adds 100 Mesh Strainer

Table 2.

Coupling Type	Description
3	Standard 3-inch aluminium coupling with corrosion resistant steel wire races to mate with F584 swivel body (uses 3-inch strainer)
4	Standard 3-inch aluminium coupling with corrosion resistant steel wire races to mate with F596 dry disconnect swivel assembly (uses 3-inch strainer)
6	Standard 2 ½-inch aluminium coupling with corrosion resistant steel wire races to mate with F1516 dry disconnect swivel body (uses 2 ½-inch strainer)
7	Standard 2 ½-inch aluminium coupling with corrosion resistant steel wire races to mate with F582 swivel body (uses 2 ½-inch strainer)

Model Variations

Table 3.

Swivel Body Type	Description
A	2 ½ - inch ANPT inlet. Available for couplings types 3, 4, 6 or 7 only
B	2 ½ - inch BSPPL inlet. Available for couplings types 3, 4, 6 or 7 only
C	3-inch ANPT inlet. Available for couplings types 3, 4, 6 or 7 only
D	2-inch ANPT inlet. Available for couplings types 3, 4, 6 or 7 only
E	3-inch BSPPL inlet. Available for couplings types 3, 4, 6 or 7 only
F	2-inch BSPPL inlet. Available for coupling type 6 only
G	3-inch BSPPL inlet. Available for coupling type 7 only
T	2-inch female Camlock inlet. Available for coupling type 7 only
X	2-inch BSPPL inlet. Available for coupling type 7 only

Pressure Drop (psi)

